

VEX IQ[®]

PLTW Chassis Bot with Sensors Build Instructions

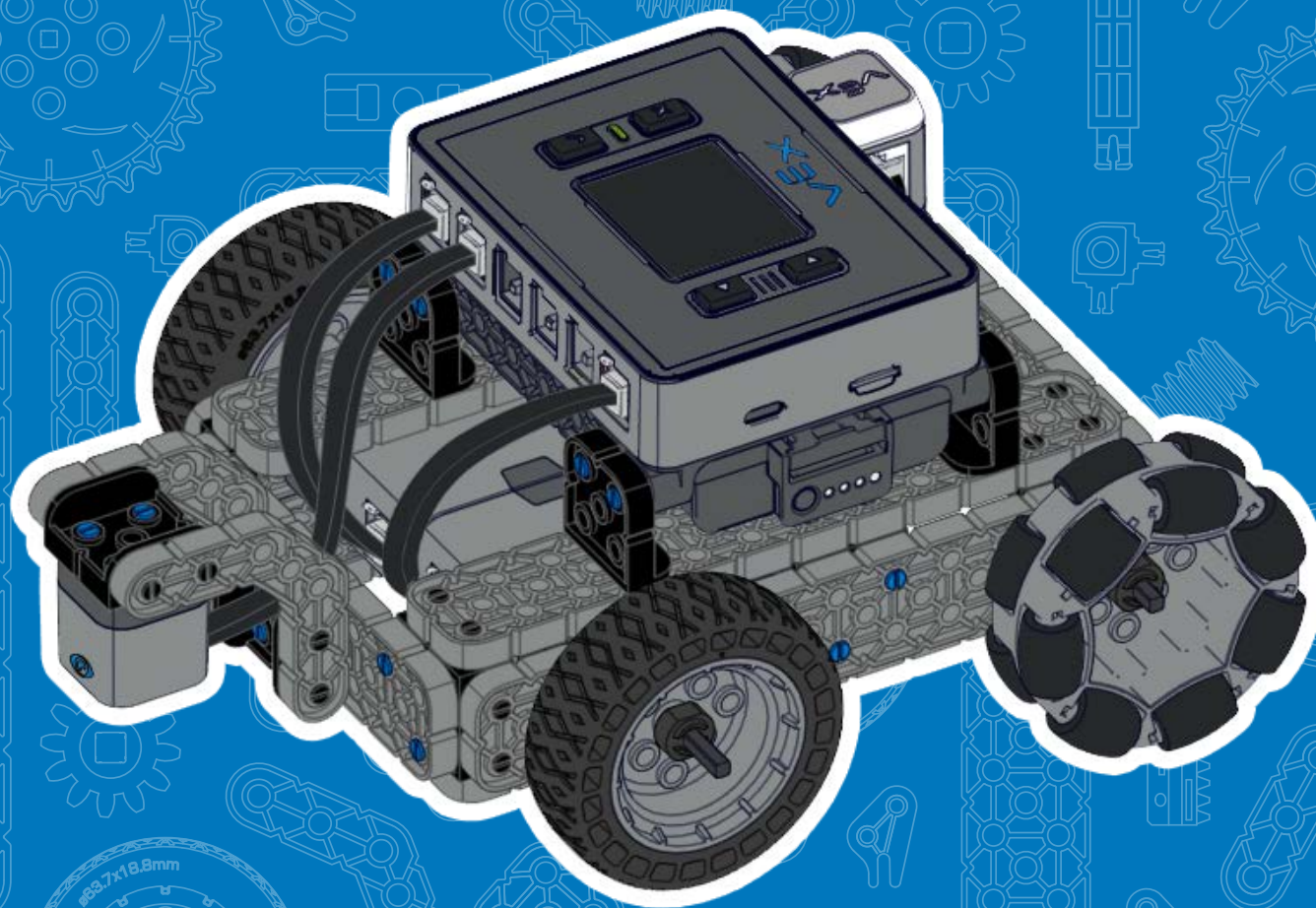

228-3304

Count before you connect • Contar antes de conectar • Compter avant de connecter • Contare i pezzi prima di collegarli • Erst zählen, dann verbinden • Policz, zanim połączysz • Tell voordat u aansluit

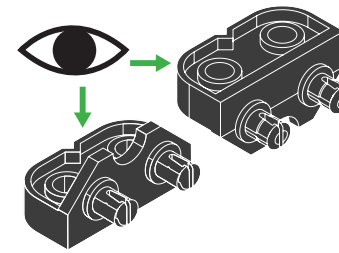
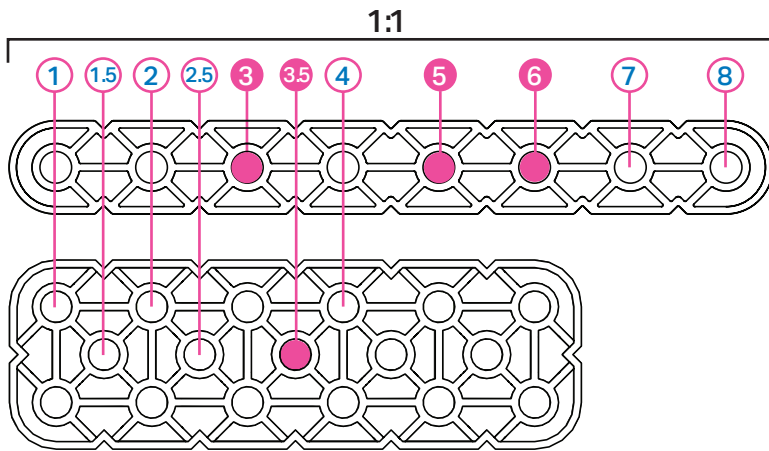

Confirm orientation
 Confirmar orientación
 Confirmez l'orientation
 Confermare l'orientamento
 Ausrichtung prüfen
 Potwierdź orientację
 Bevestig orientatie

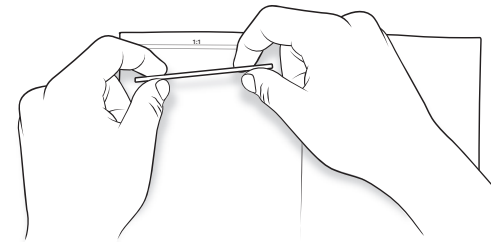

Check pieces against actual size in manual
 Verificar partes contra tamaño real en el manual
 Vérifiez les pièces contre leurs tailles réelles dans le manuel
 Controllare le dimensioni dei pezzi nel manuale rispetto alla grandezza naturale
 Bauteile mit der originalgröße in der anleitung vergleichen
 Sprawdź elementy względem rzeczywistego rozmiaru w instrukcji
 Check stukken tegen de werkelijke grootte in de handmatige



Scan to download the
VEX IQ Part Ruler PDF

Alert	Correct	Pivot	Incorrect	Alternate view	Size	Notice	Rotate	Flip
Alerta	Correcto	Pivote	Incorrecto	Vista alternativa	Tamaño	Aviso	Girar	Voltear
Alerte	Correcte	Pivot	Incorrecte	Autre vue	Taille	Avis	Faire tourner	Retourner
Attenzione	Corretto	Imperniare	Non corretto	Vista alternativa	Dimensione	Fare attenzione	Ruotare	Capovolgere
Warnung	Richtig	Drehbar lagern	Falsch	Andere ansicht	Größe	Hinweis	Drehen	Umdrehen
Ostrzeżenie	Prawidłowo	Obracać się na osi	Nieprawidłowo	Widok alternatywny	Rozmiar	Zwróć uwagę	Obróć	Przerzuć
Waarschuwing	Correct	Draaien	Verkeerd	Vitzicht	Grootte	Opmerken	Draaien	Omdraaien

Puller

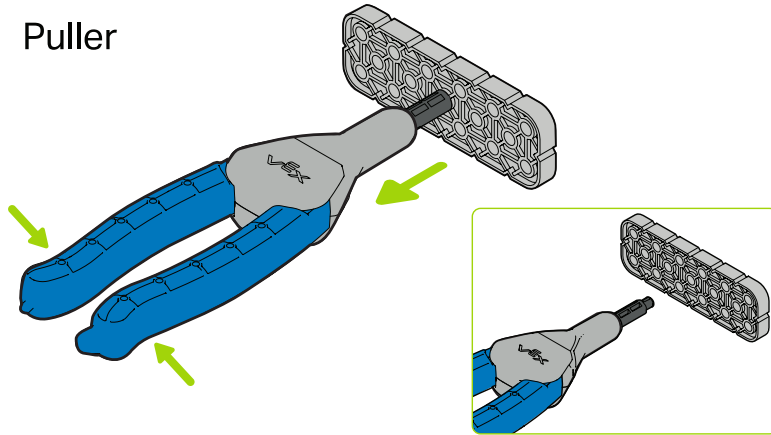

Pusher

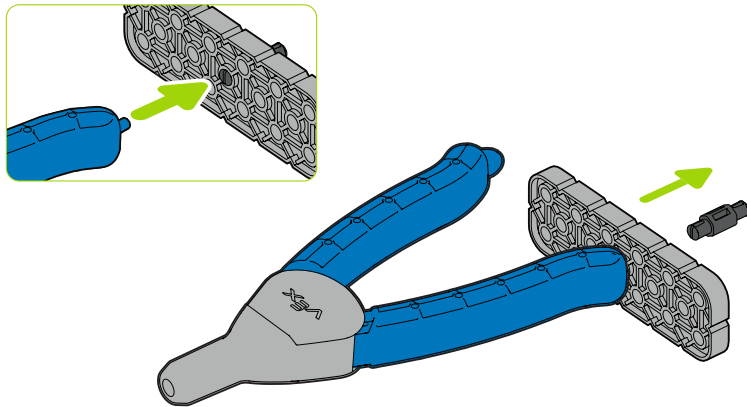

Lever

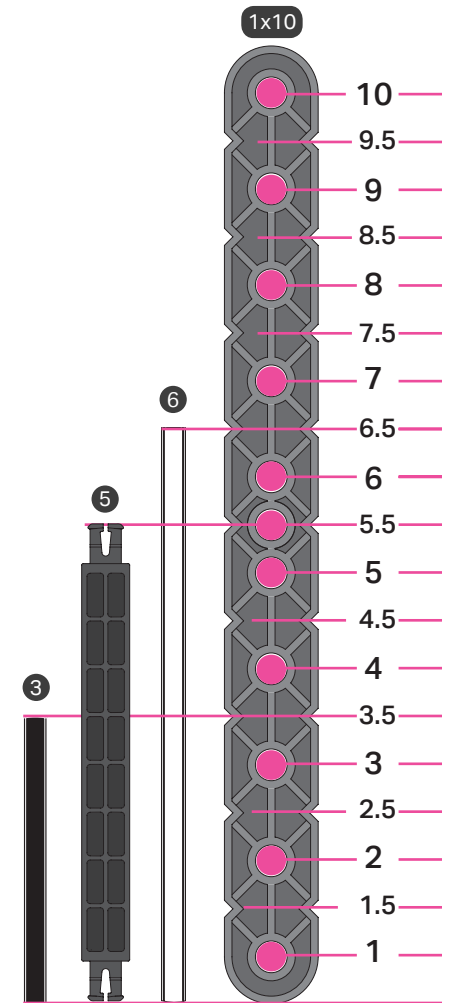
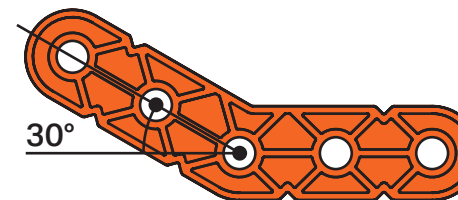
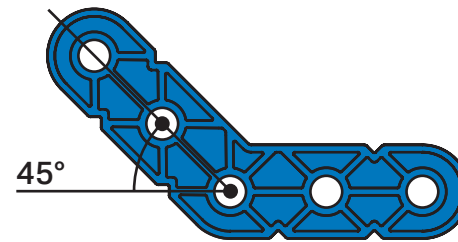
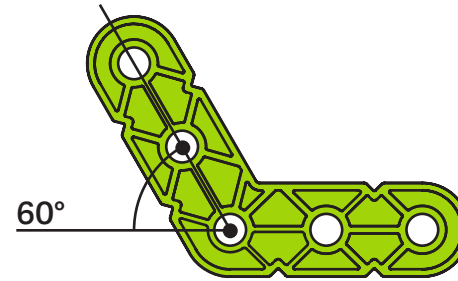
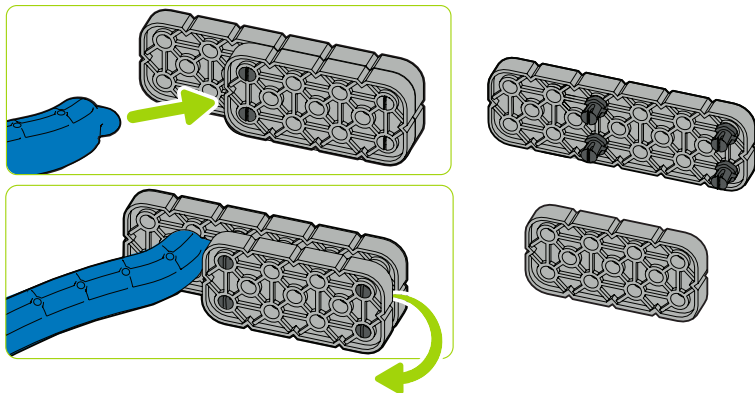



47x

1x1

Connector Pin

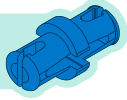

4x

2x Wide,
2x2 Corner Connector

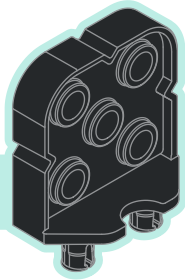

6x

Double 2x Wide,
2x2 Corner Connector

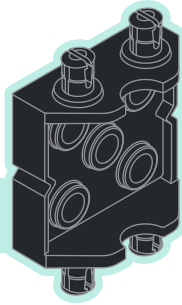

4x

Large Chassis
Corner Connector



4x

2x Wide, 2x2 Offset
Corner Connector

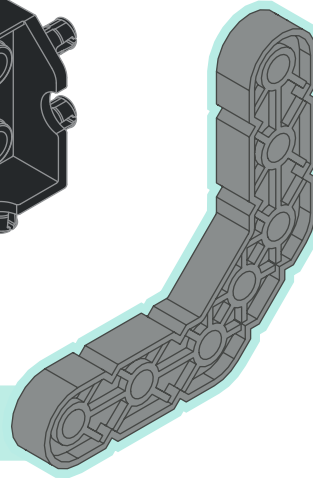



4x Washer



4x Rubber Shaft Collar



4x ³ Pitch Motor Shaft

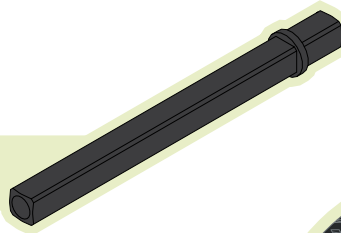

2x ^{200mm} Travel Tire



2x ^{200mm} Travel Omni-Directional Wheel

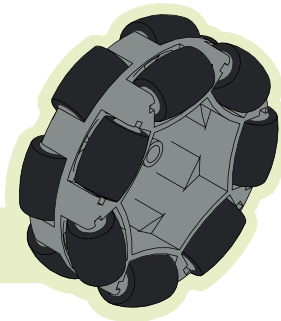



1x Touch LED

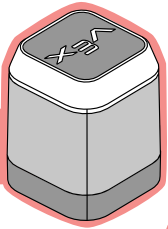

1x Optical Sensor

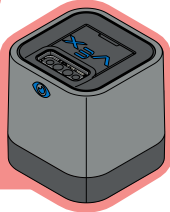

2x Smart Motor

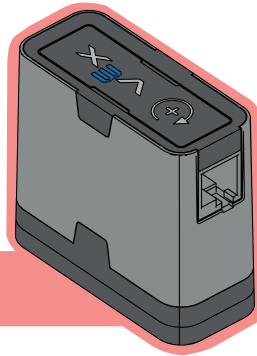

4x **200mm**
Smart Cable

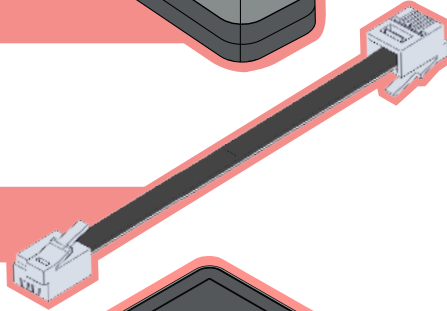

1x Robot Brain

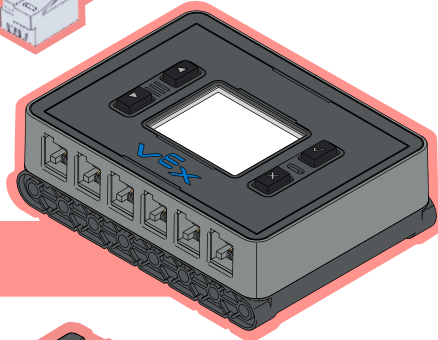

1x Robot Battery

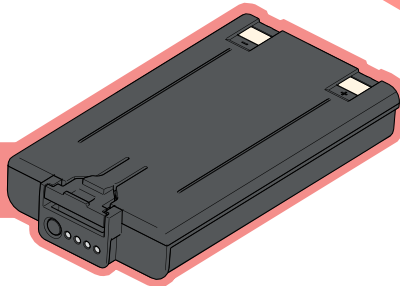



4x

2x2
Beam

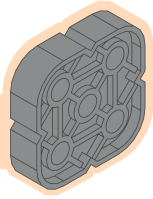

2x

2x8
Beam

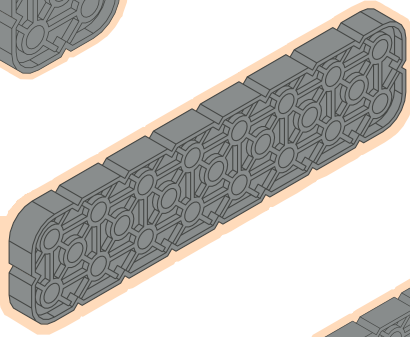

6x

2x12
Beam

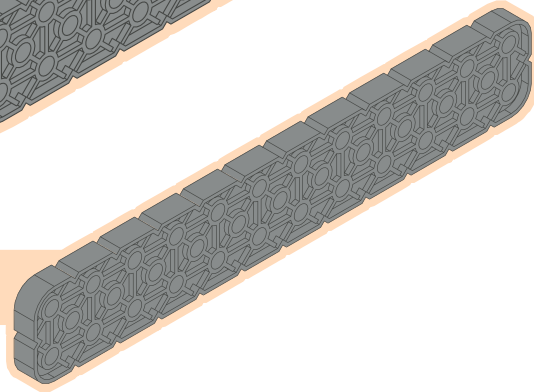

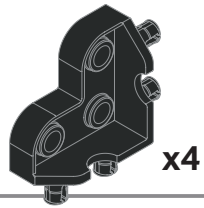

2x12

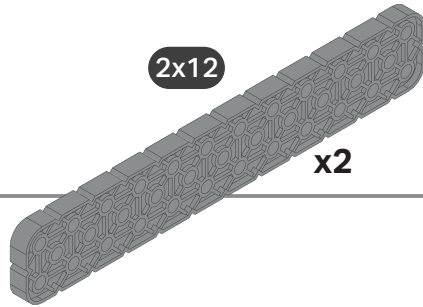

x2

x4
1x1

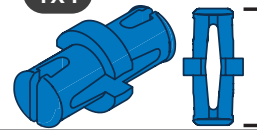

1:1

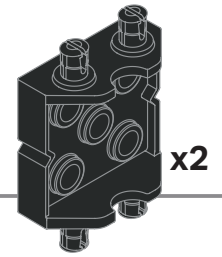

x2

1 2X

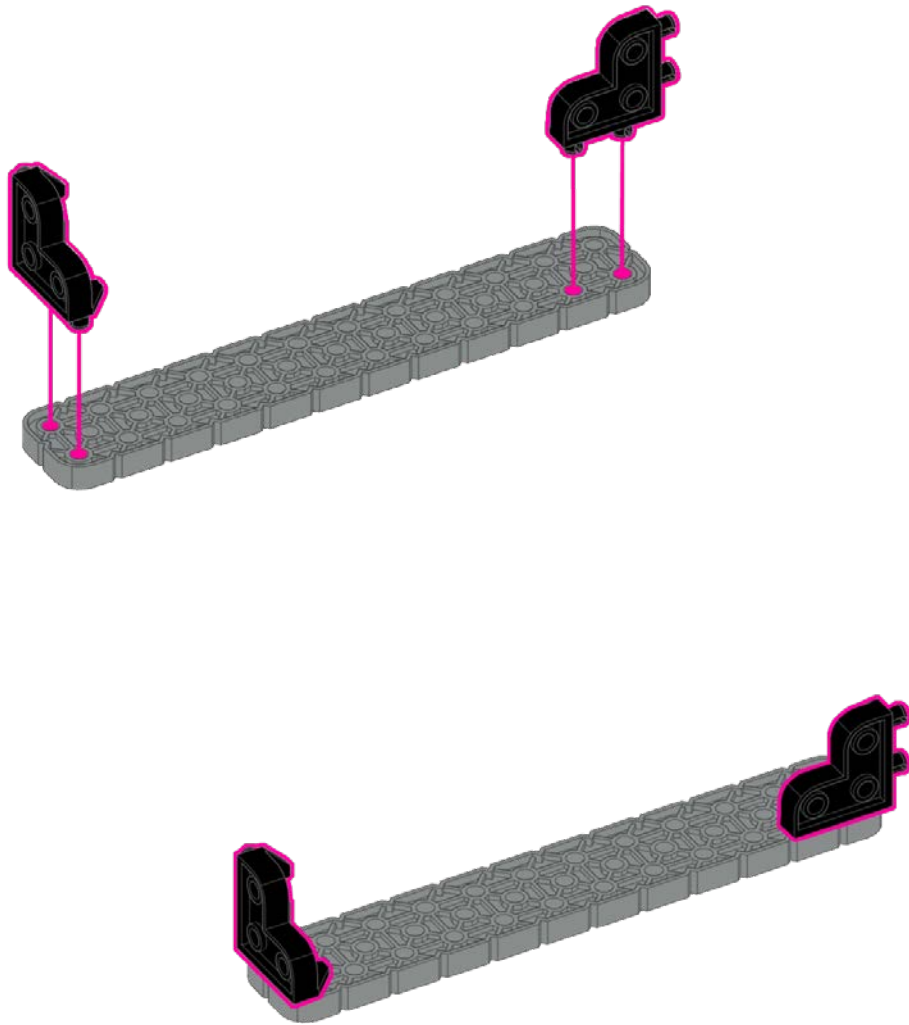

2 2X

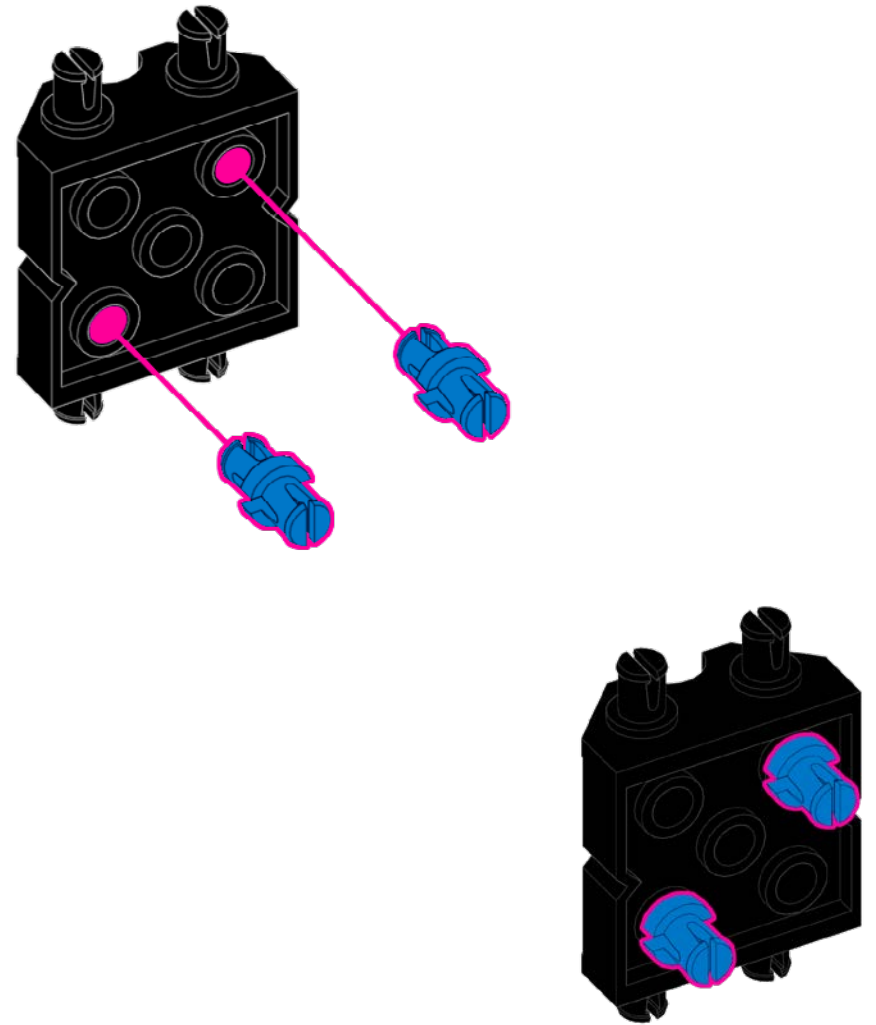

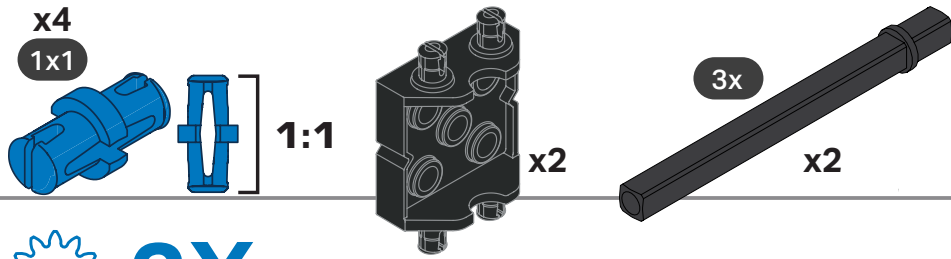

3 2X

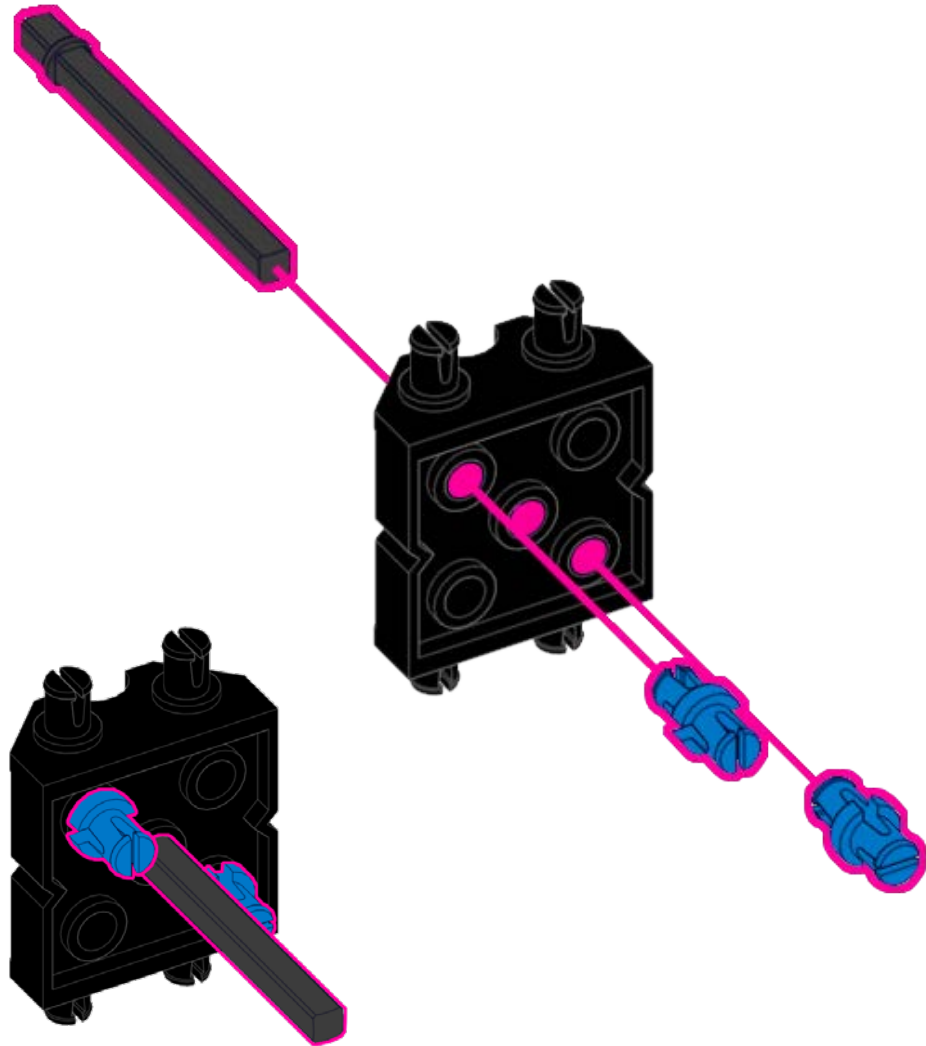

4 2X

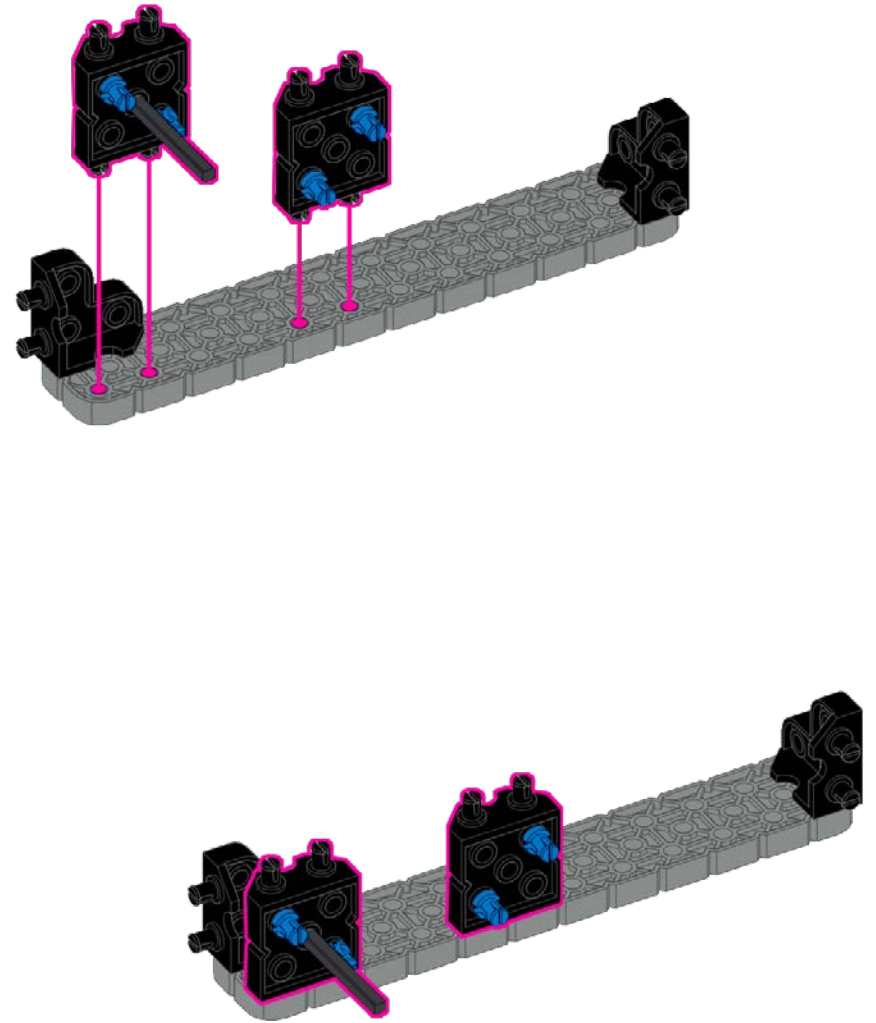

2x12

x2

x8

1x1

2x2

x4

1:1

5 2X

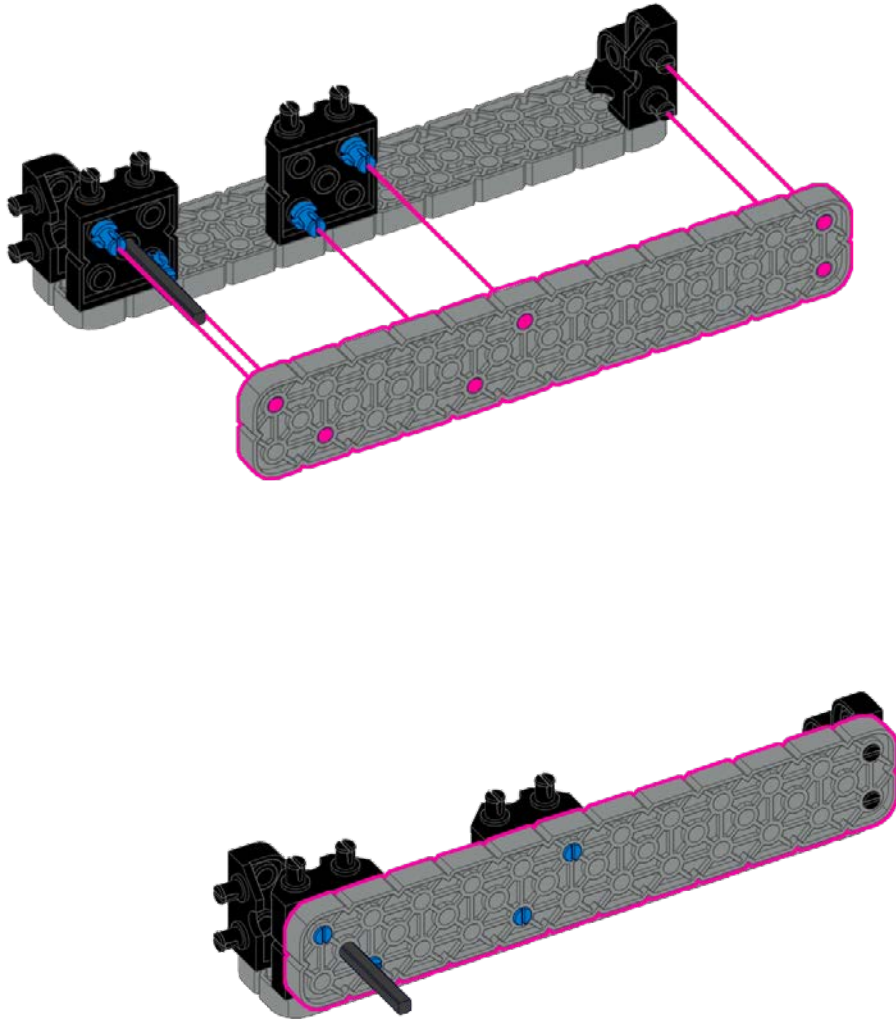

6 2X

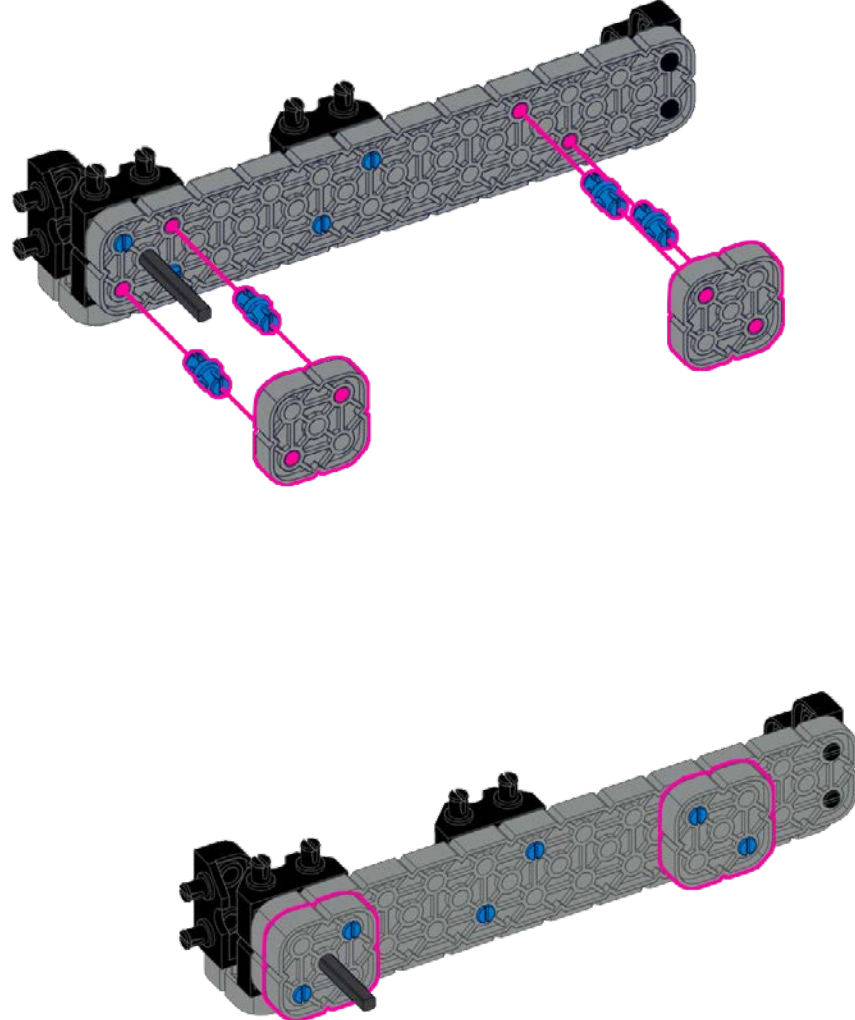

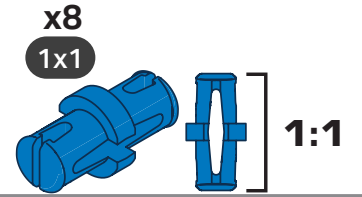
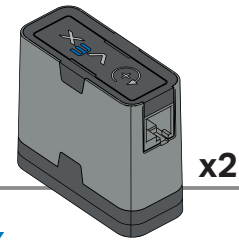
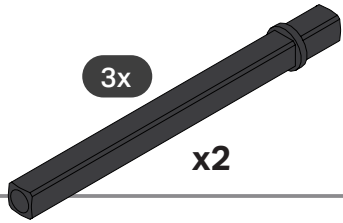

7 2X

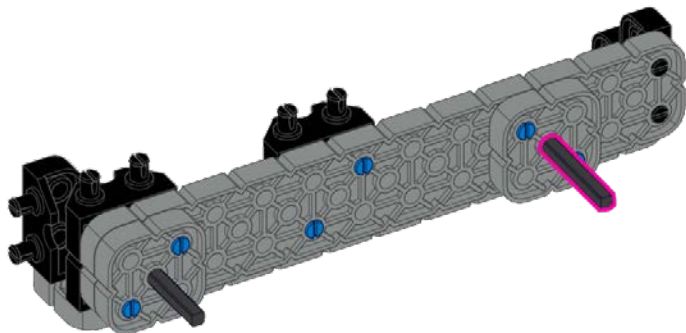
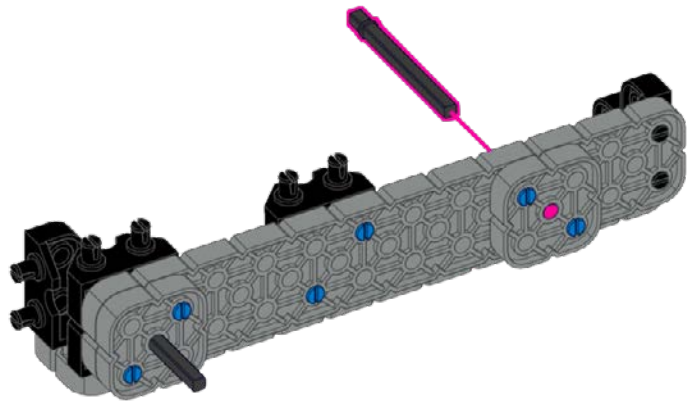

8 2X

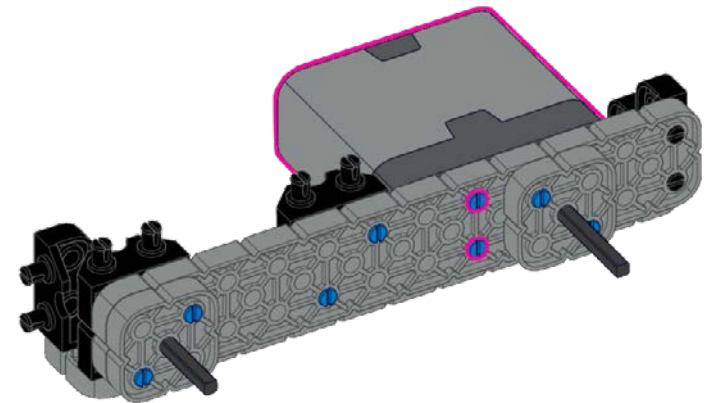
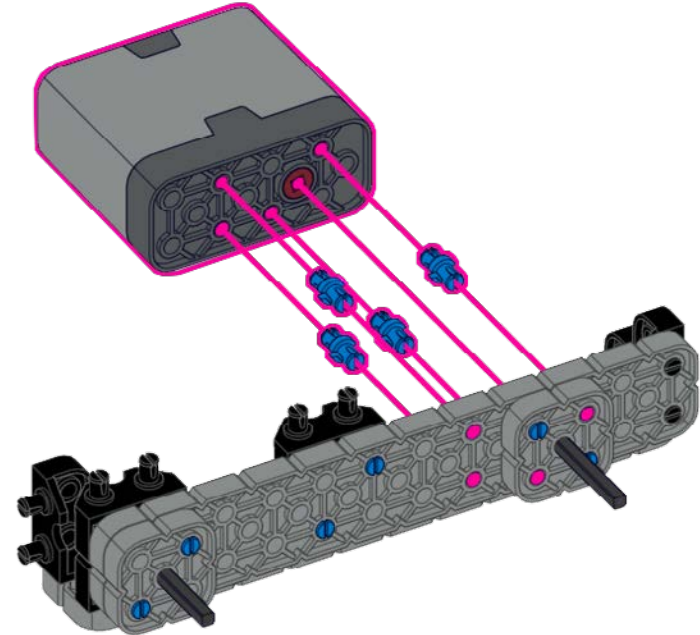

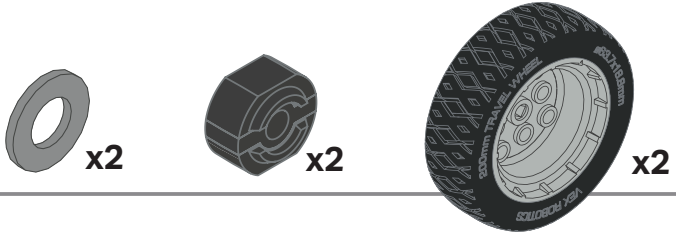

9 2X

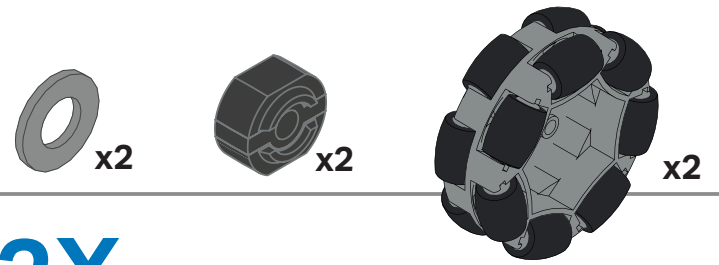
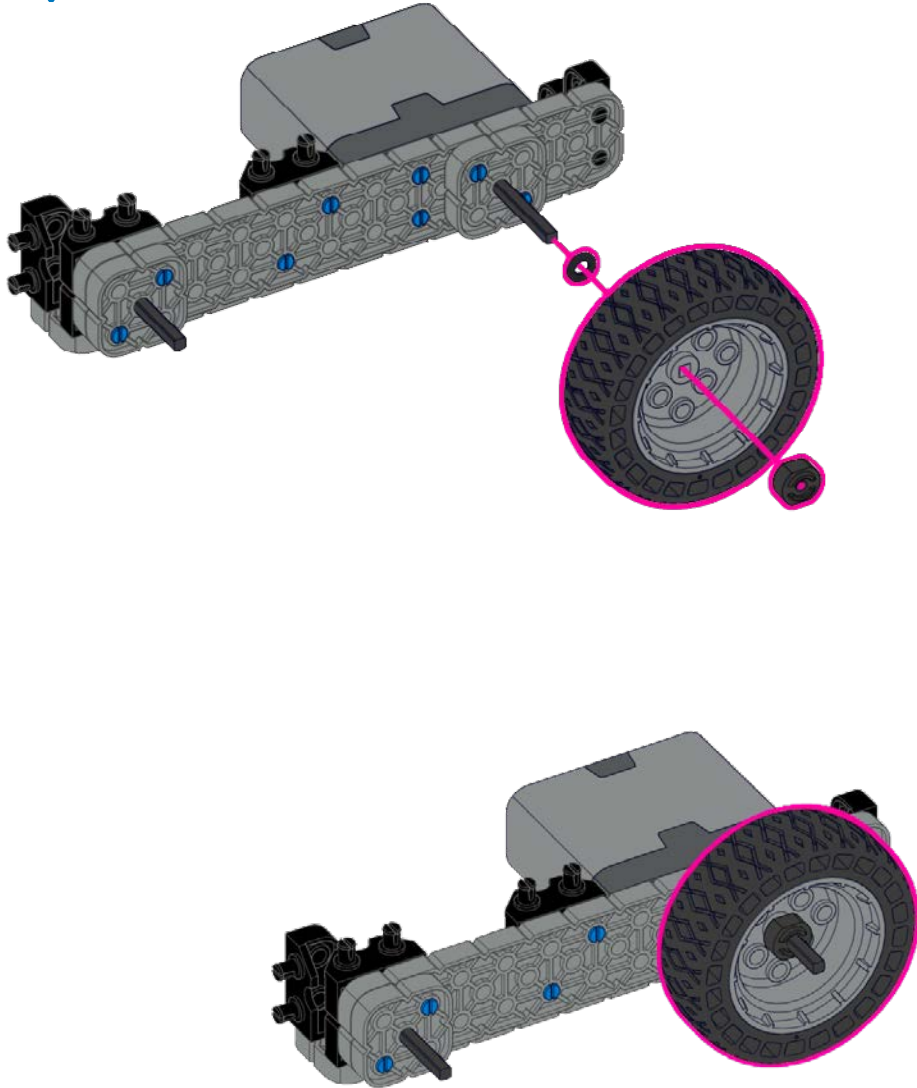

10 2X

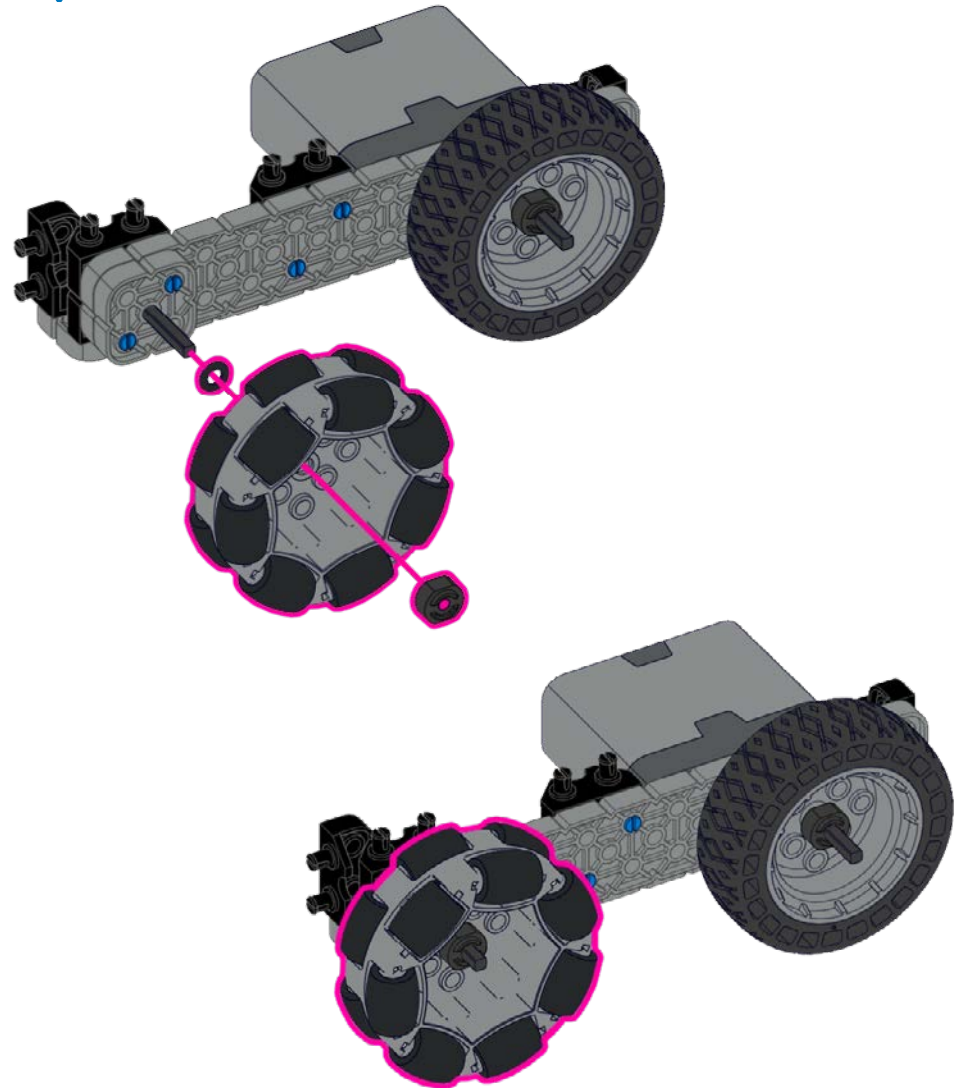

11 2X

2x12

x2

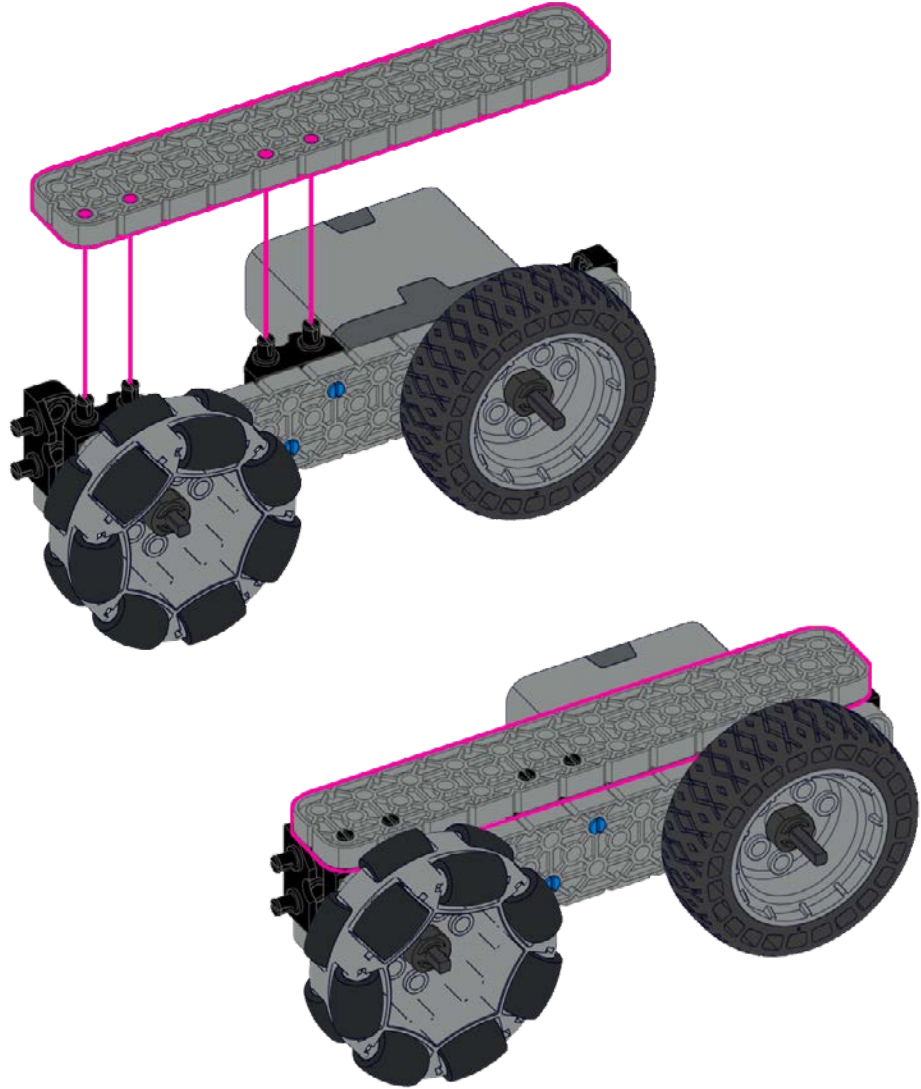
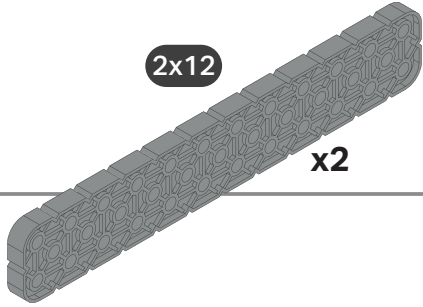

2x8

x1

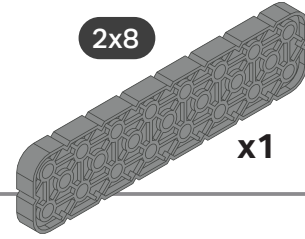

12

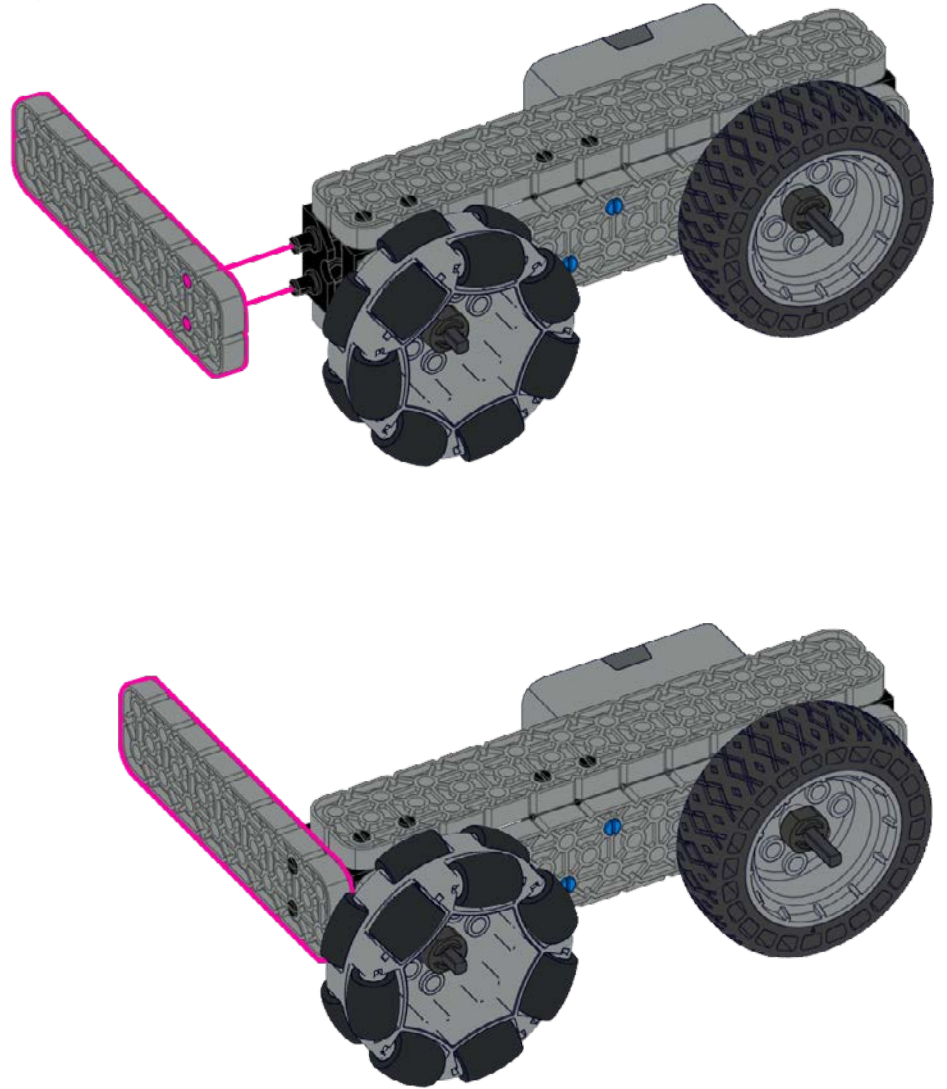

13

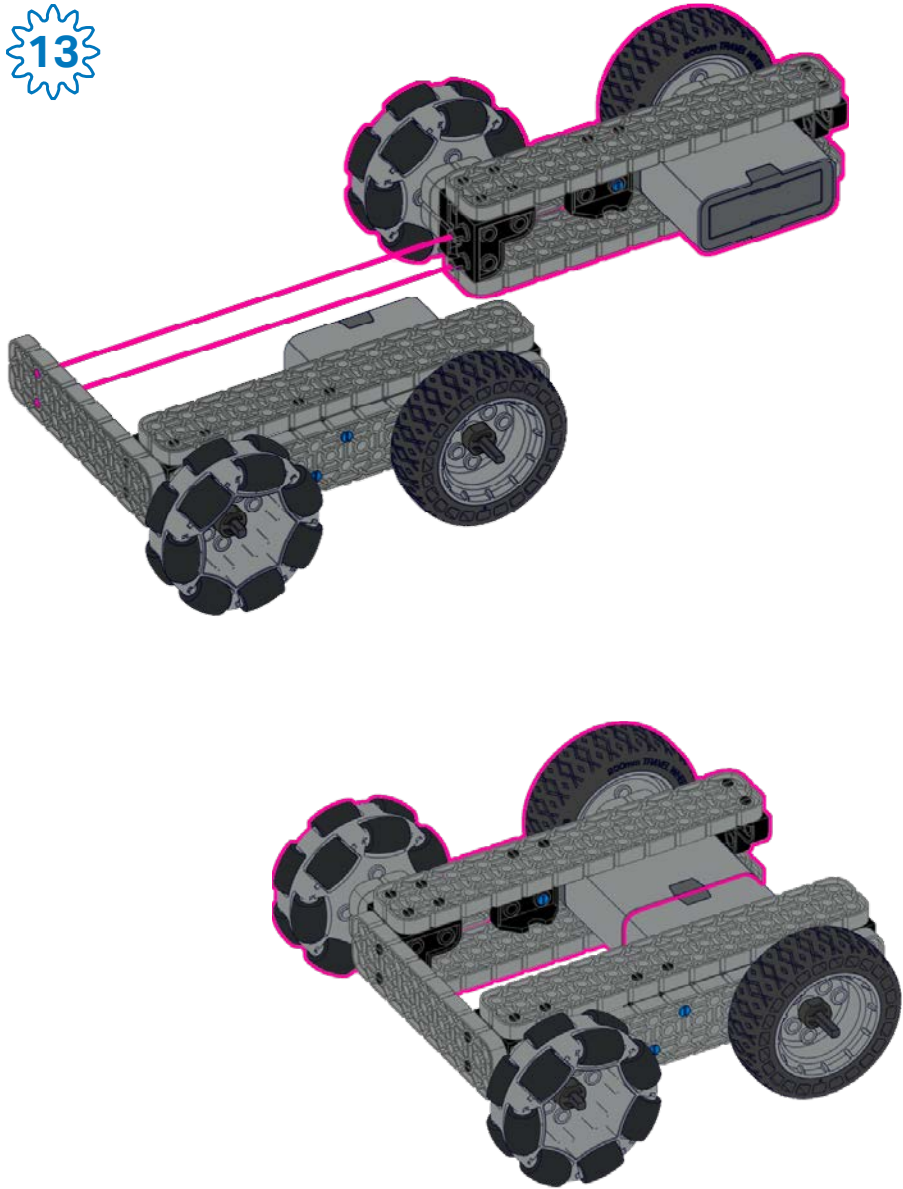

14

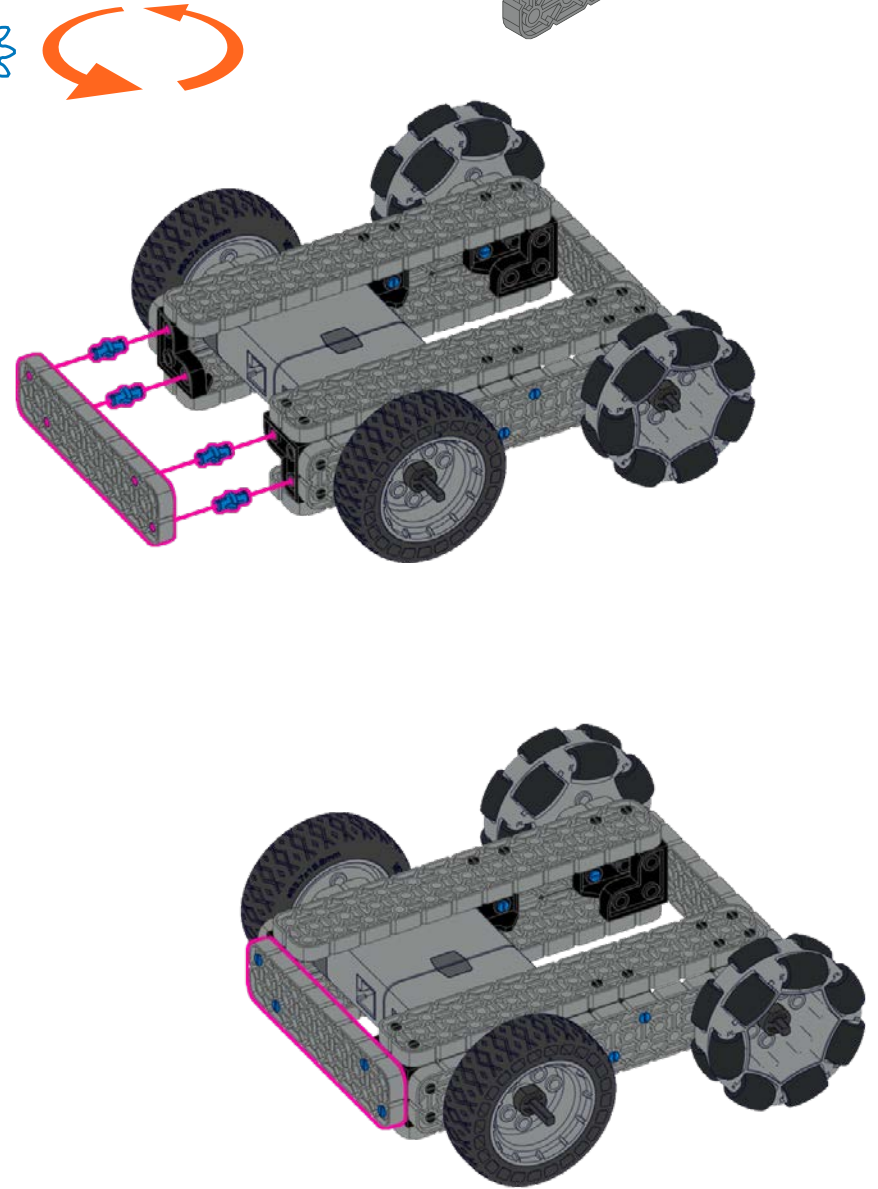

x4
1x1

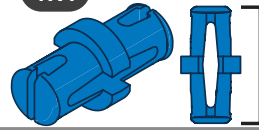

1:1

2x8

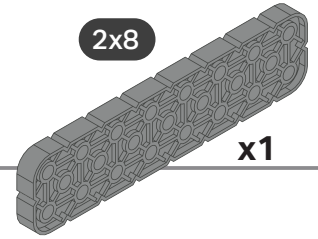

x1

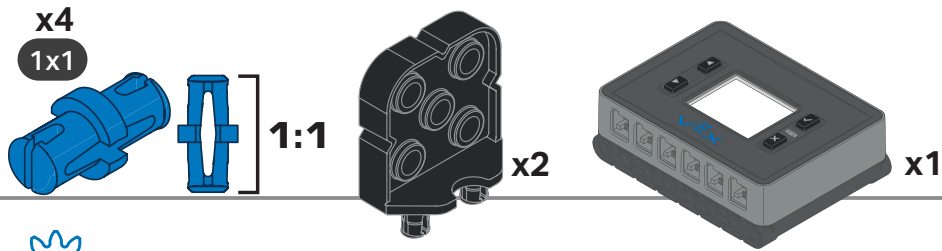

15

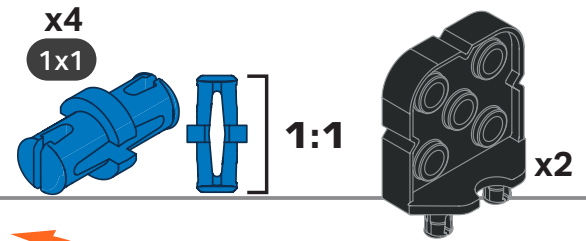
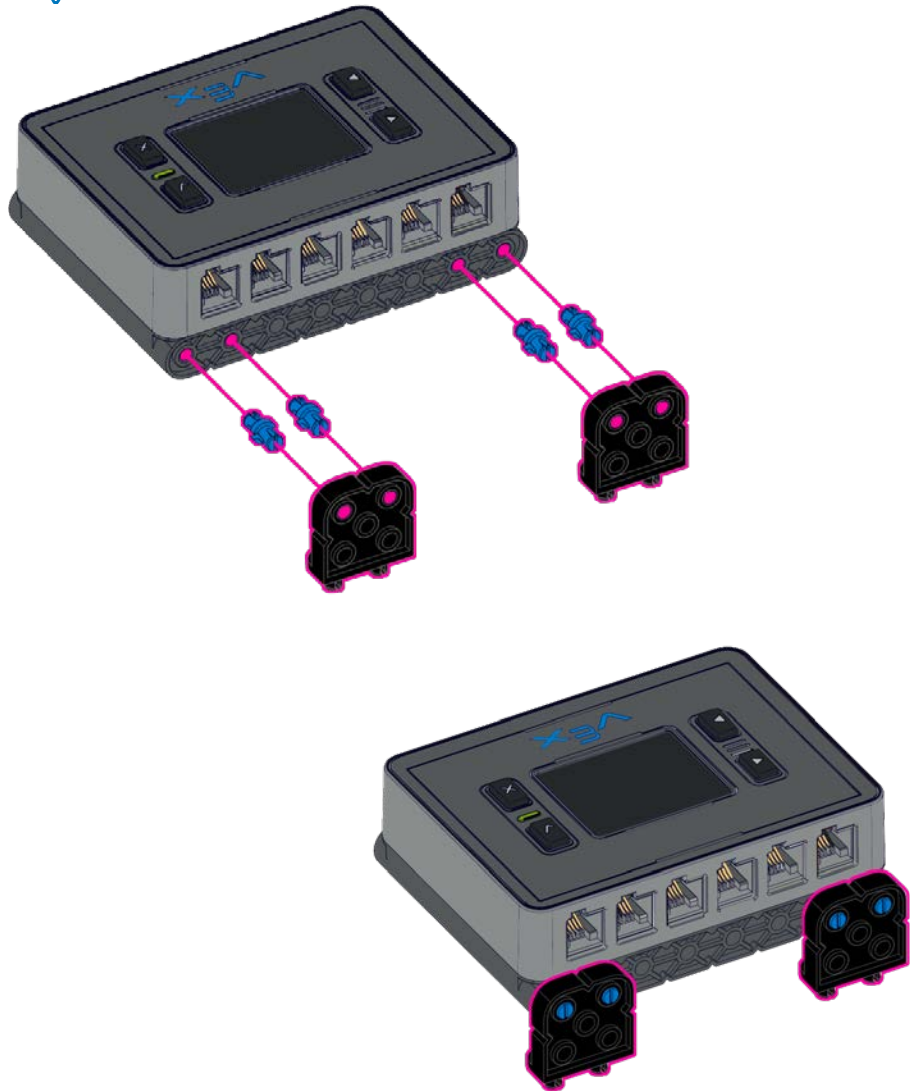

16

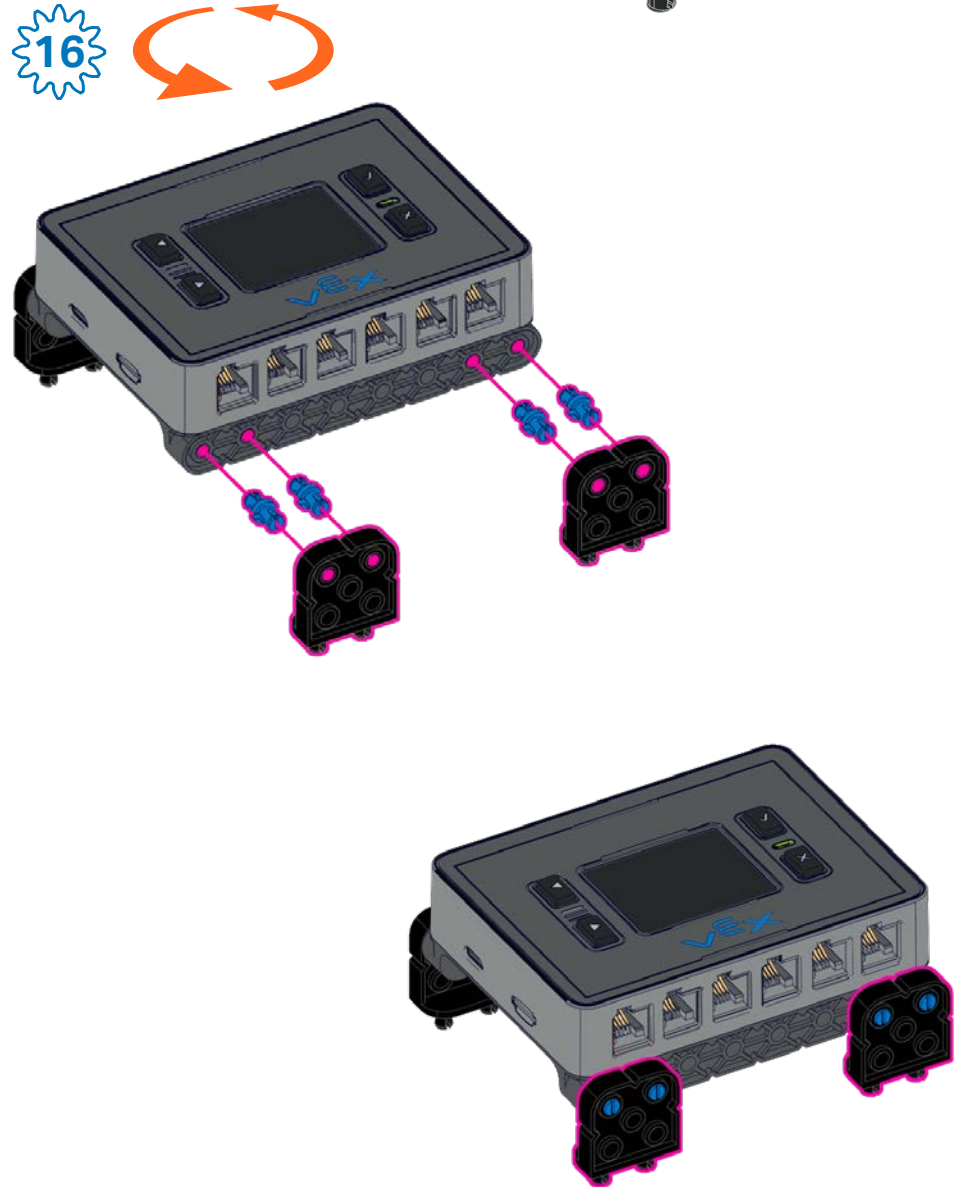

17

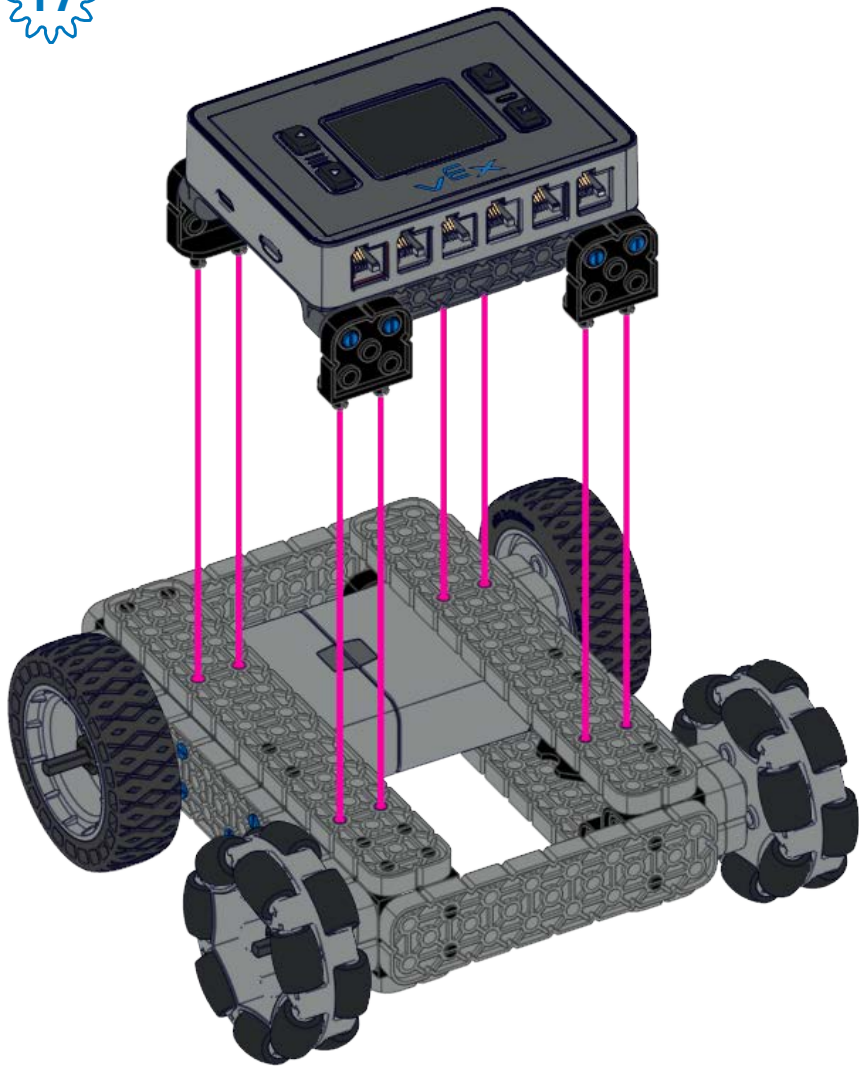

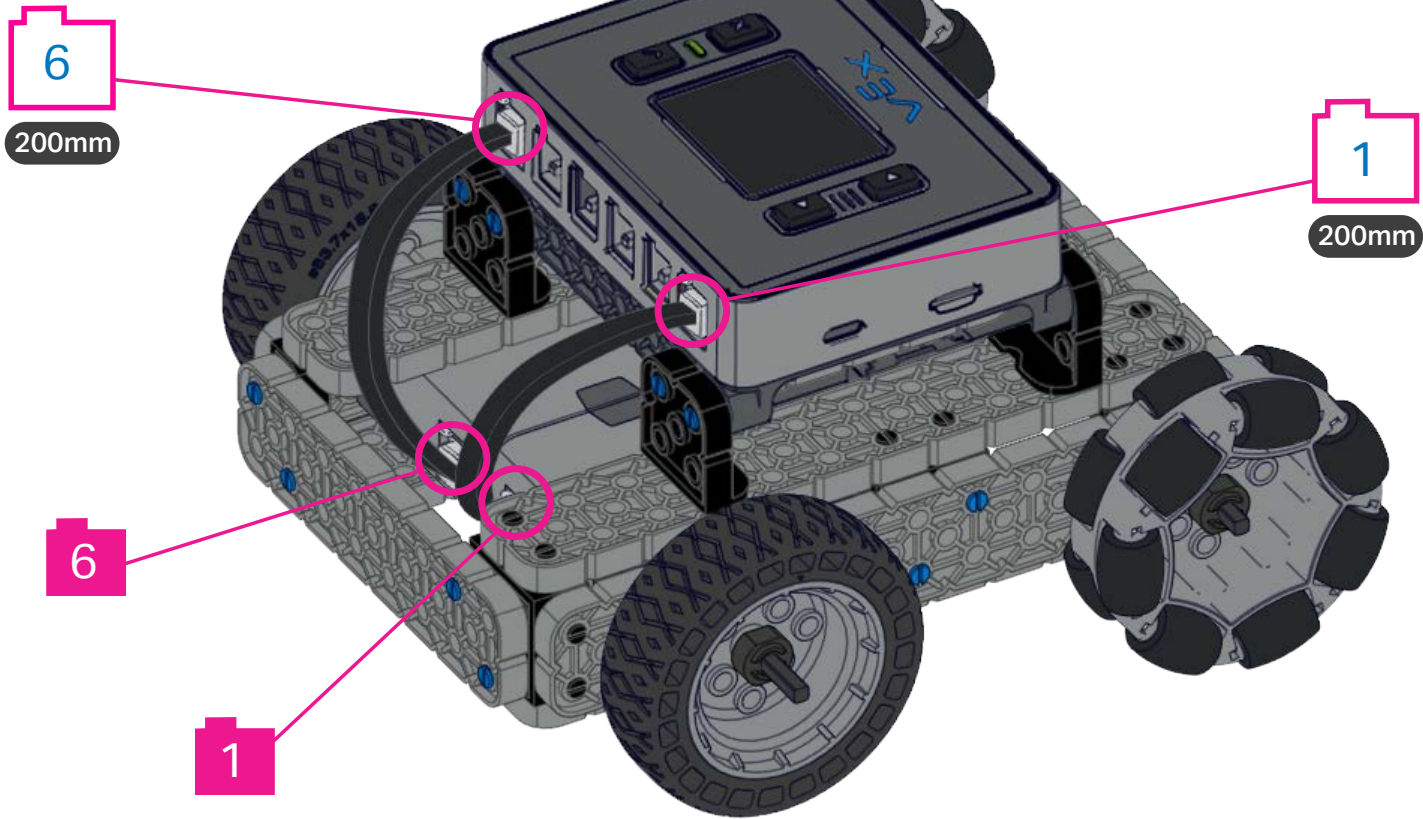
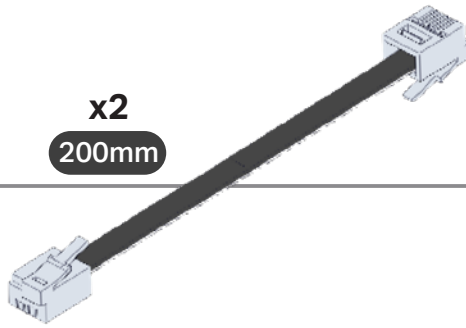

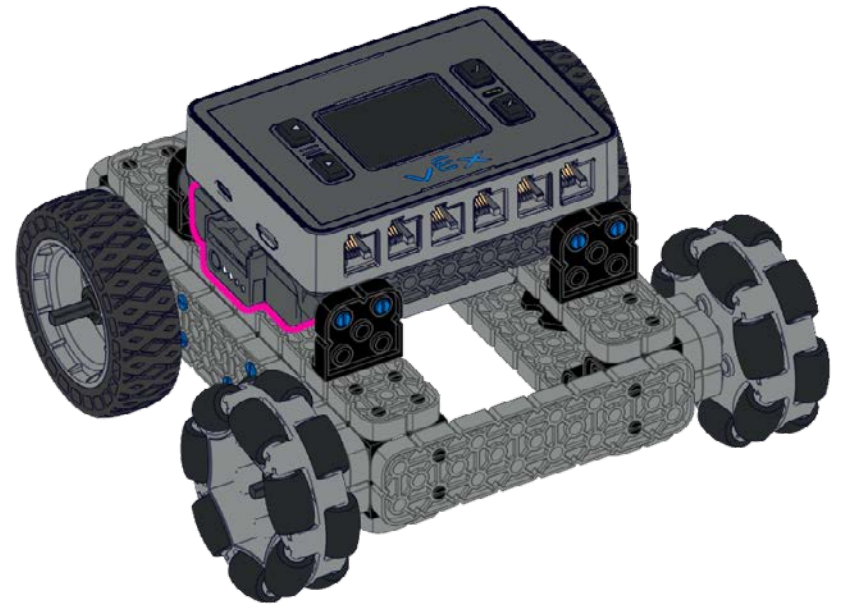
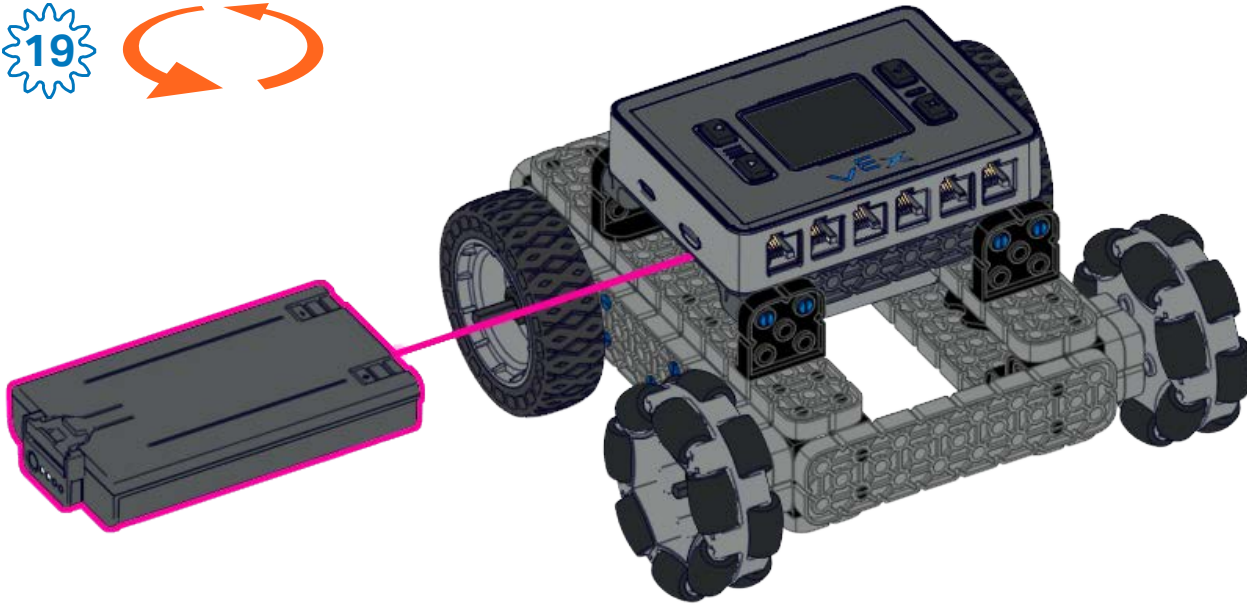
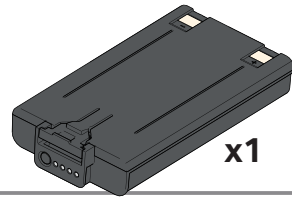

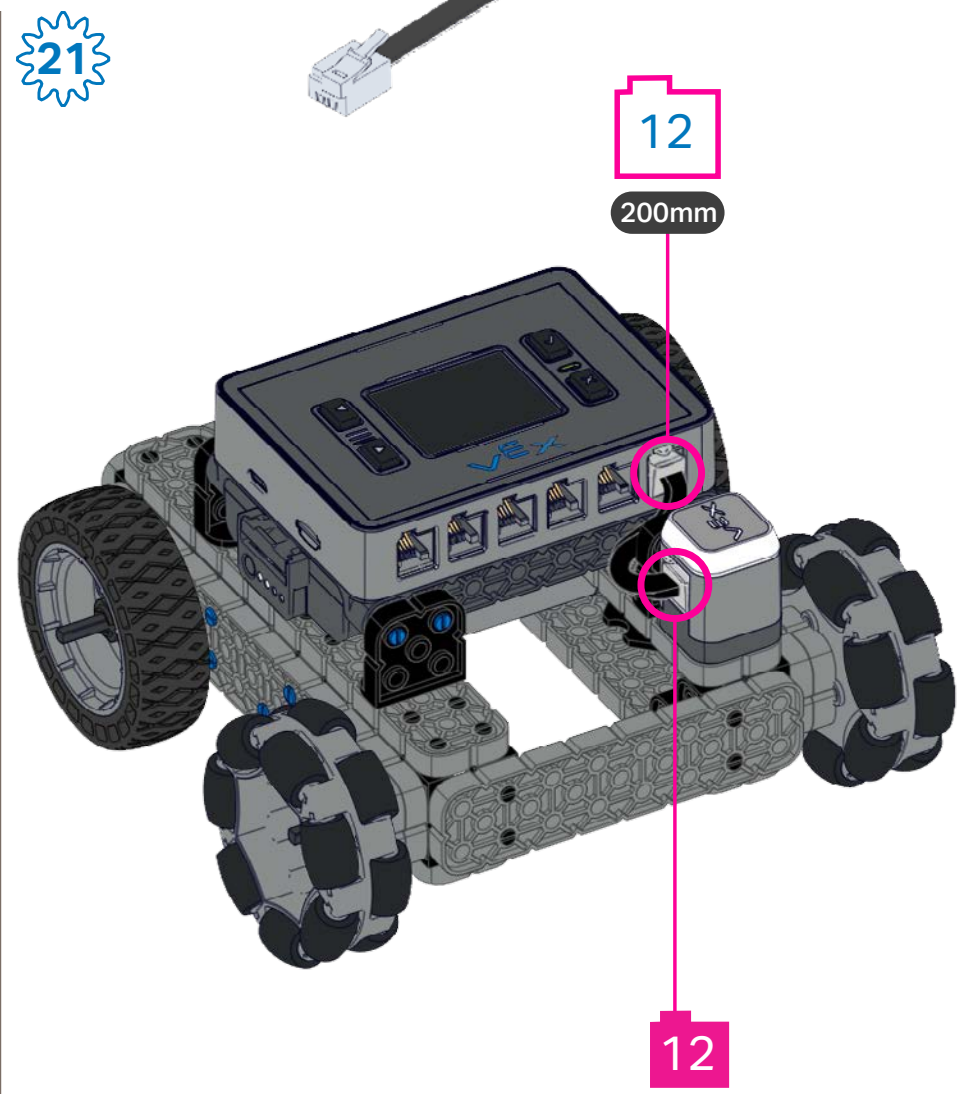
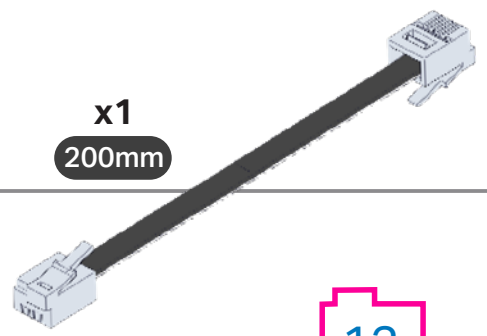
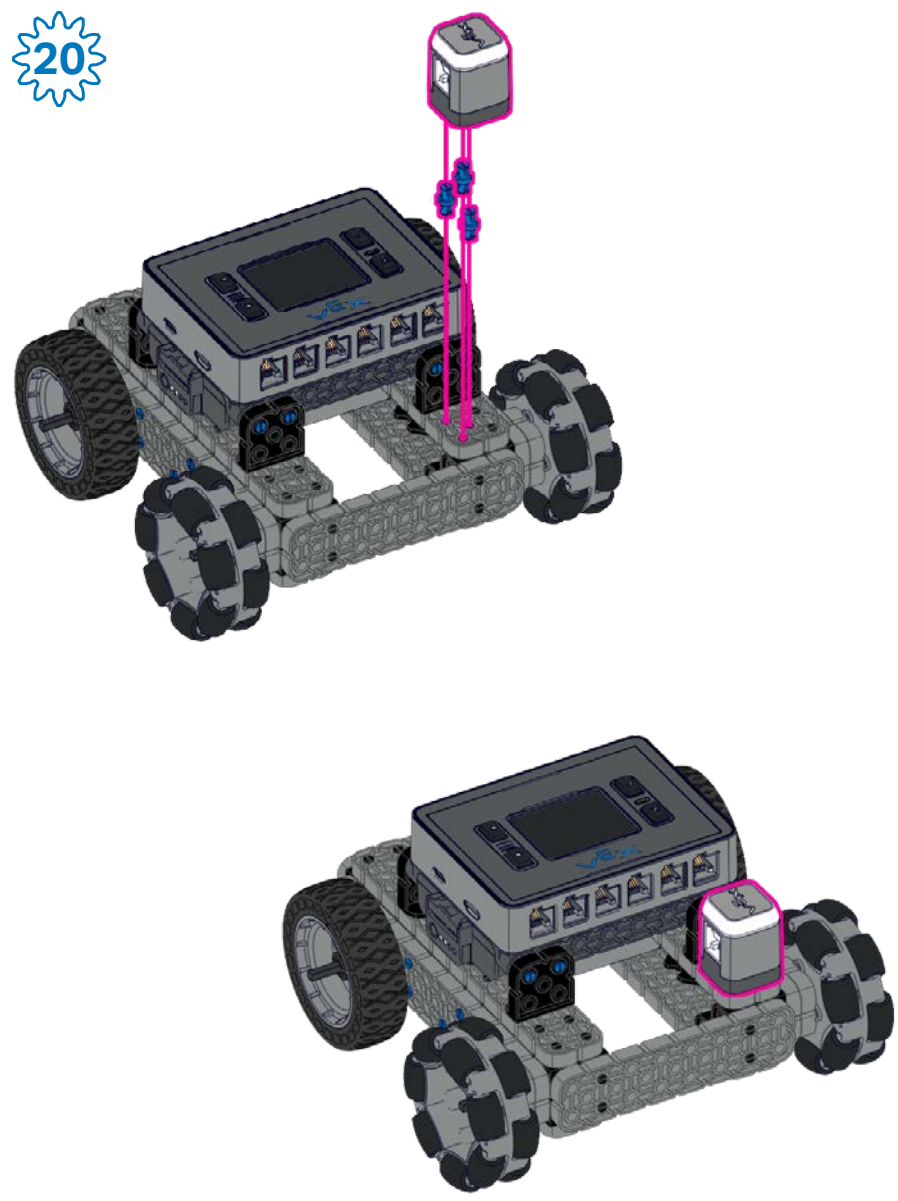
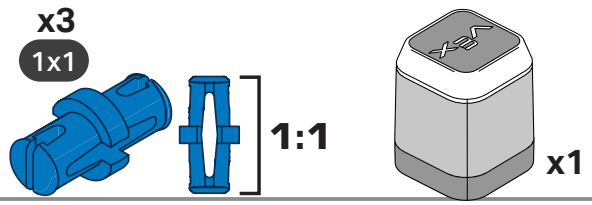

x4
1x1

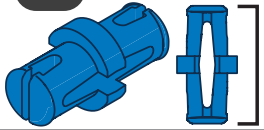

1:1

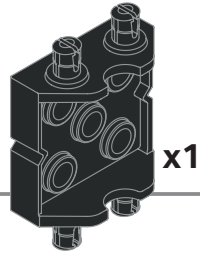

x1

22

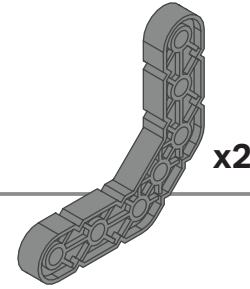
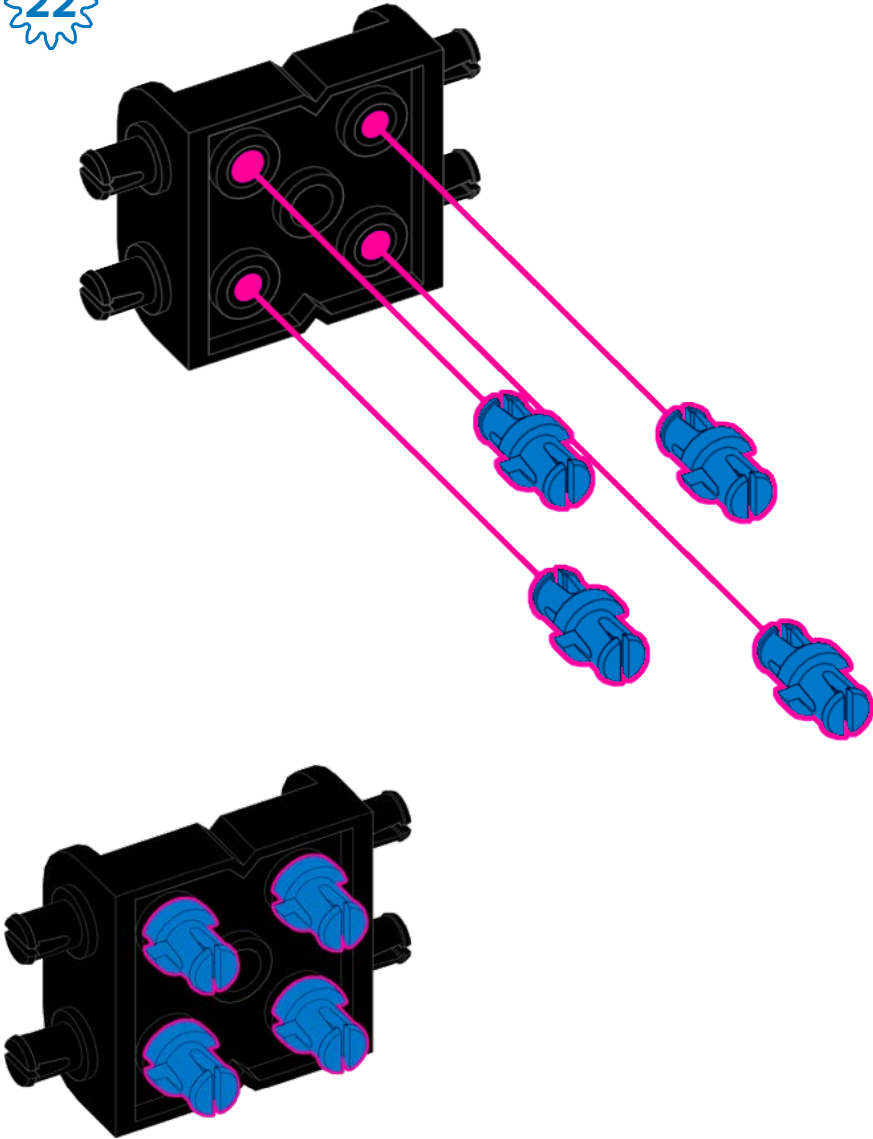

x2

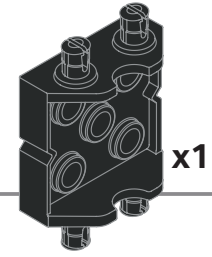

x1

23

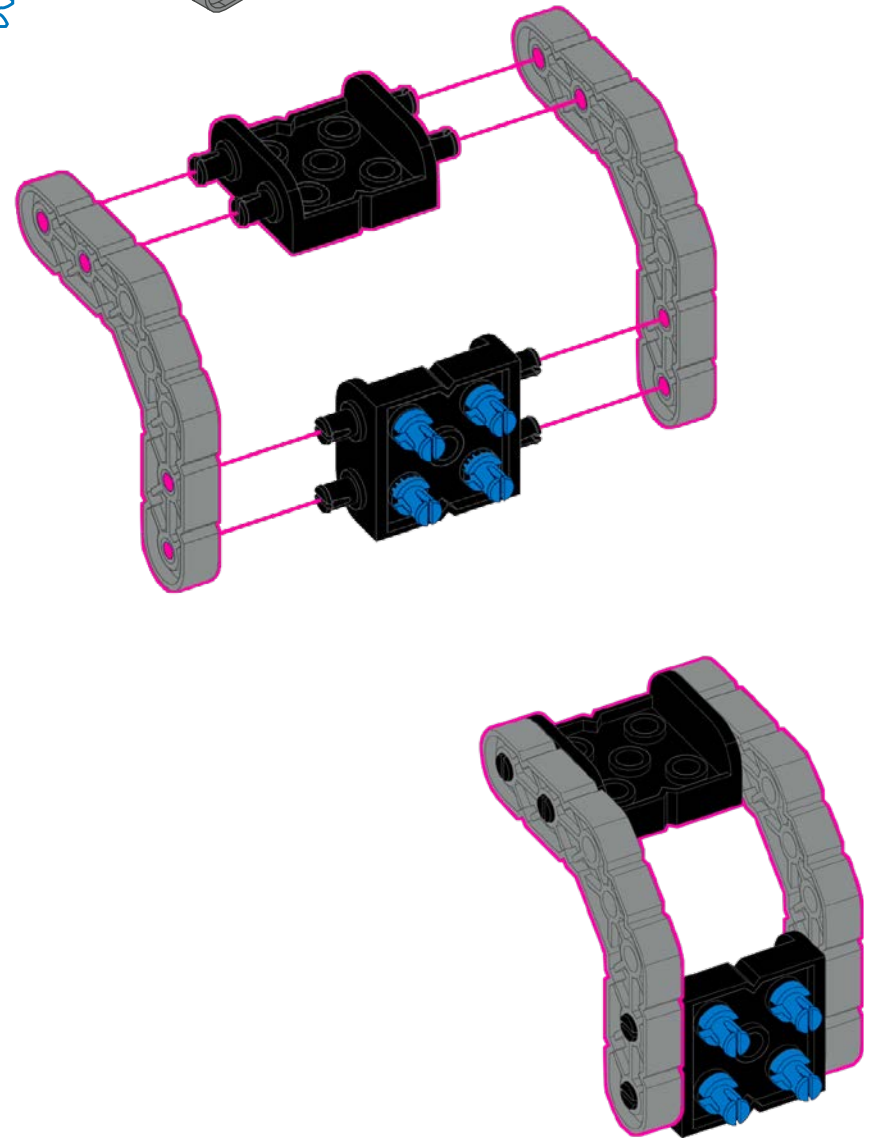

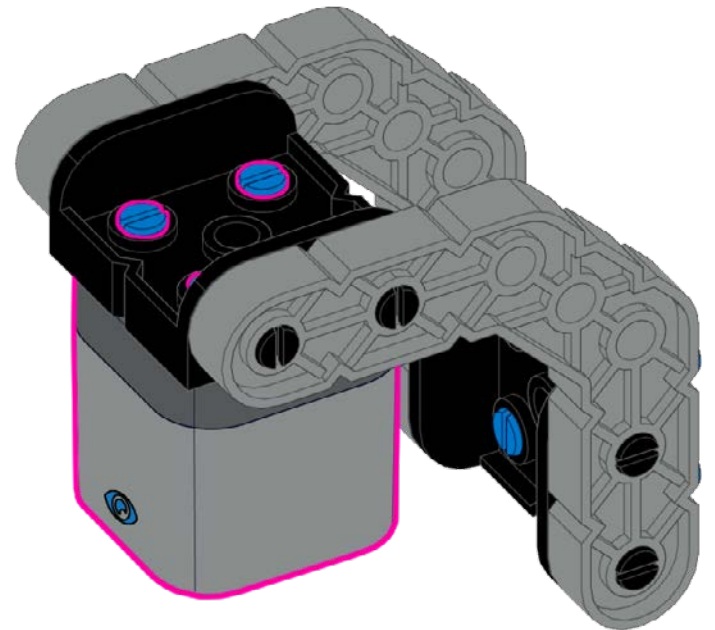
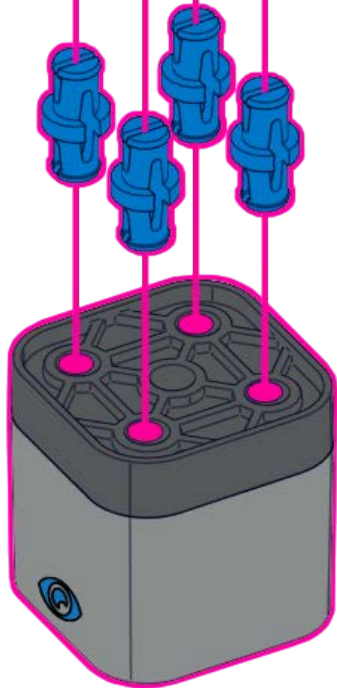
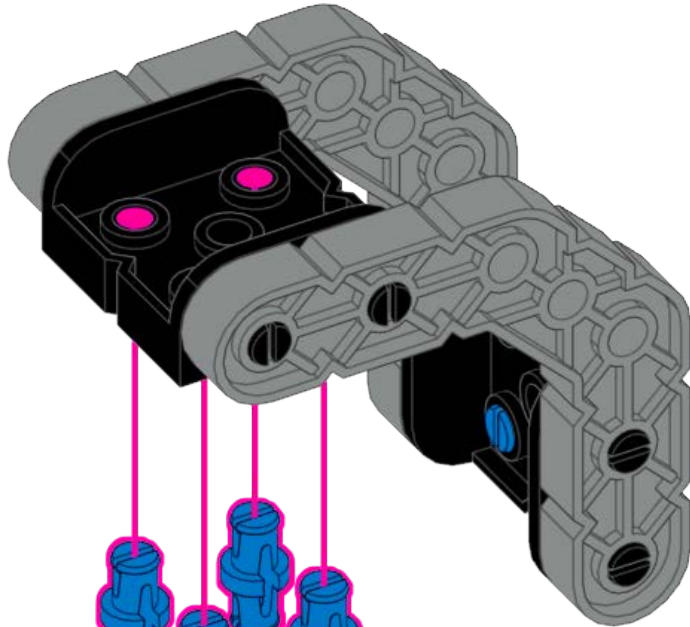
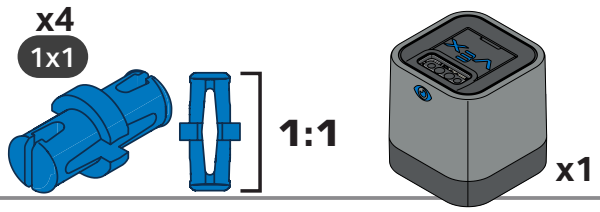

25

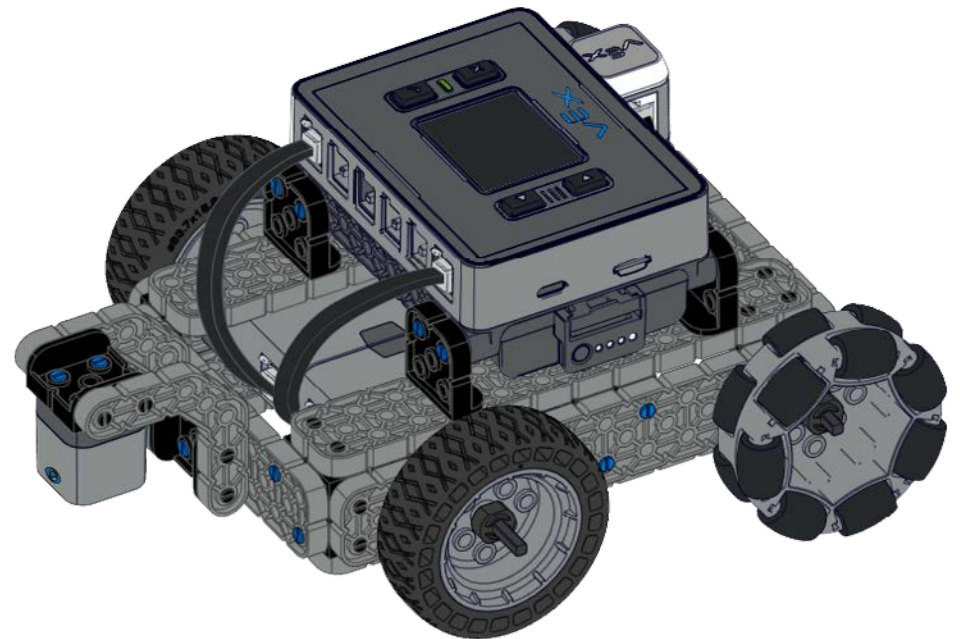
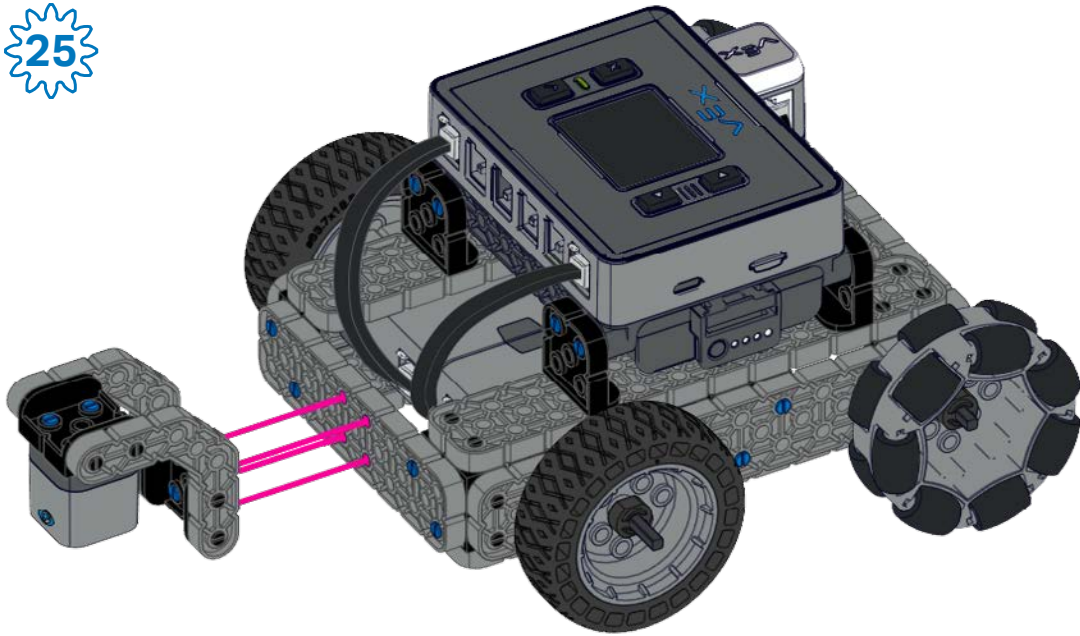

26

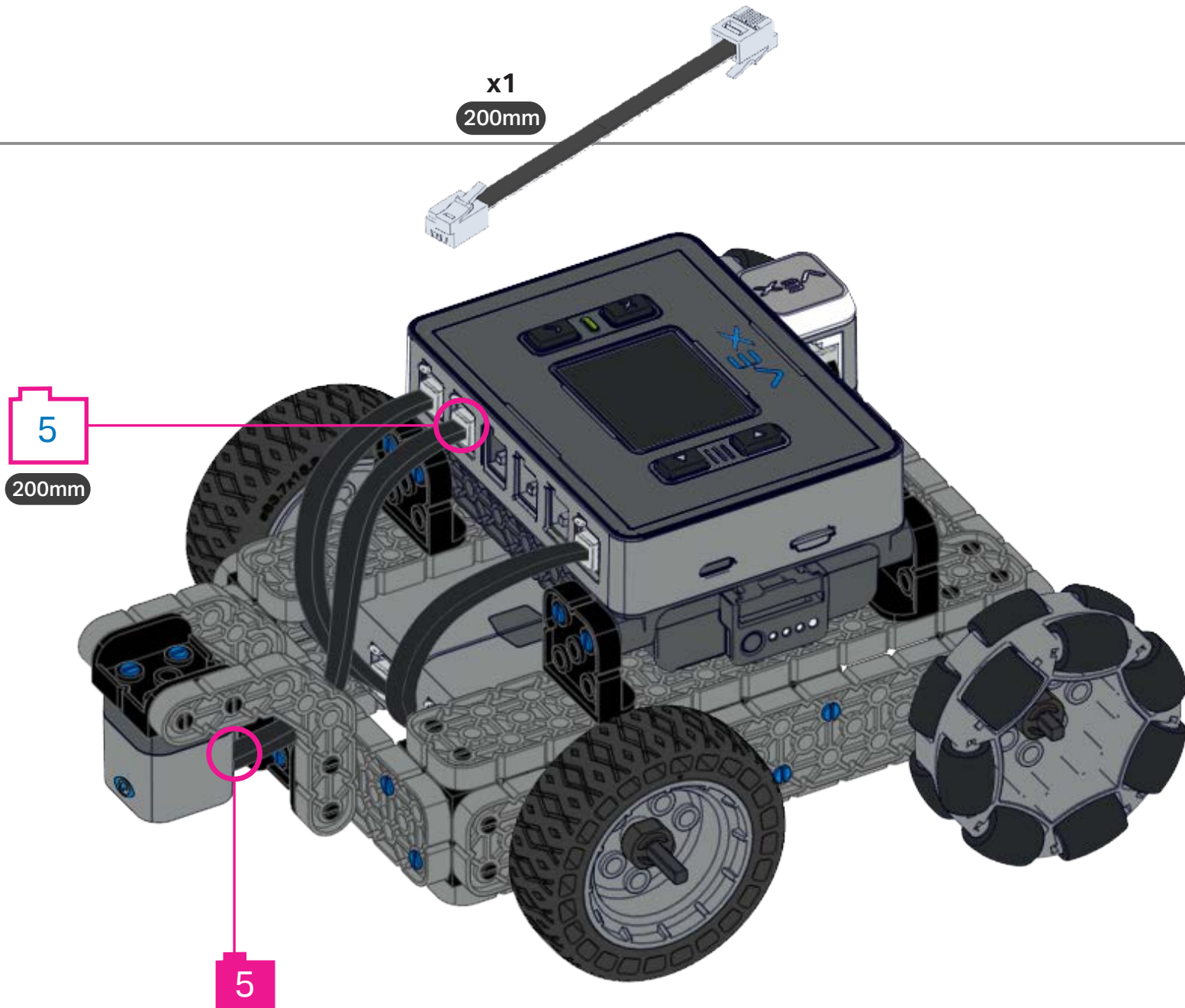

PLTW Chassis Bot with Sensors

228-3304-751 Rev1



PLTW

Distributed in the U.S.A. by VEX Robotics, Inc., 6725 W. FM 1570, Greenville, TX 75402, U.S.A. ©2022 VEX Robotics, Inc. All rights reserved. Tous droits réservés. PLTW Chassis Bot with Sensors was created in collaboration with VEX Robotics, Inc., for Project Lead The Way, Inc., (PLTW), as part of curricular materials.